

FSIREM Installation Guide

WARNING

Installation **MUST** carry out by a qualified and licensed electrician.



IMPORTANT REMINDER

1. Only to be used on Martec or Four Seasons "AC" motor ceiling fans.
2. The supply to the remote control receiver should be connected through a mains switch, ie. existing wall switch.
3. Disconnect from power at wall switch before working on remote control receiver or ceiling fan.
4. Install receiver into the ceiling fan canopy of the fan to ensure proper protection.
5. This unit is to be used for the control of ceiling fan and in a AC230/240V 50Hz power supply only.
6. Do not install in damp locations or immerse into water. (For indoor use only.)
7. Do not pull on or cut leads shorter.
8. Do not drop or bump the unit.

NB: The battery will weaken with age and should be replaced before leaking takes place as this will damage the transmitter. Dispose of used battery properly, keep the battery out of reach of children. DO NOT use this product with other brands or variable solid-state speed controllers.

OPERATION INSTRUCTIONS

Ensure that the isolation switch is in ON position and remote controller is installed with battery.

FUNCTIONS OF TRANSMITTER

Transmitter should be pointing to IR sensor if you would like to operate ceiling fan by remote controller.

- | | |
|--------------|--|
| ON | : Press and release immediately to turn on the light. |
| OFF | : Press and release immediately to turn off the light. |
| DELAY | : Press and release immediately to set that the light will be off after 3 minutes automatically. |
| HI | : Turn on ceiling fan at high speed. |
| MED | : Turn on ceiling fan at medium speed. |
| LOW | : Turn on ceiling fan at low speed. |
| OFF | : Turn off ceiling fan. |

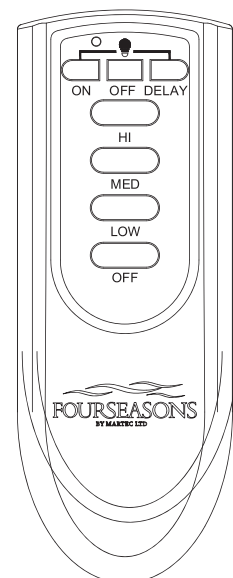

WARNING Installation MUST carry out by a qualified and licensed electrician.

INSTALLATION INSTRUCTIONS

1. This remote controller is ONLY applicable to drop rod styles.
2. Follow the wiring connection diagrams below and IR sensor MUST be installed outside the canopy.
3. Incorrect wire connection would damage the receiver.

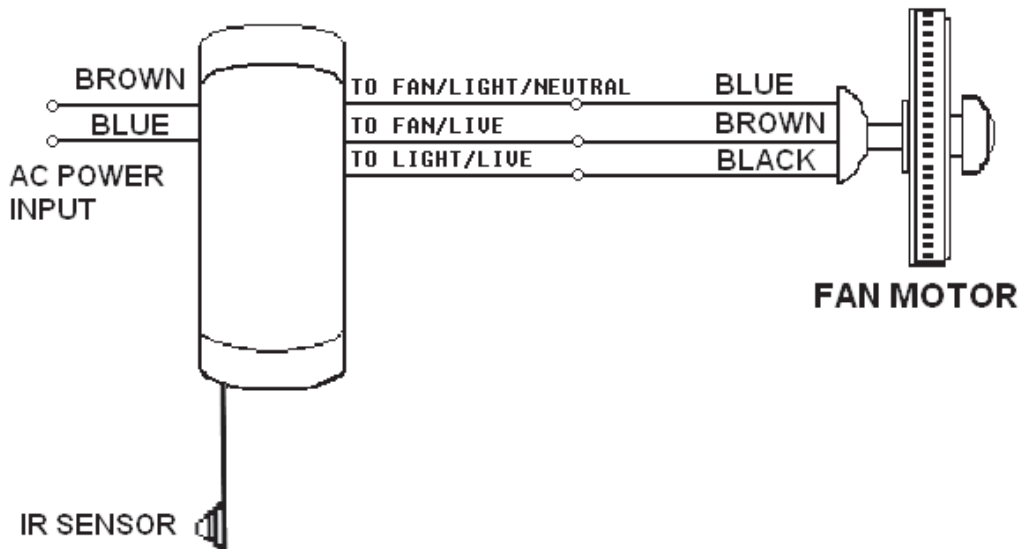

4. Once the connection is made. Insert the receiver into the drop rod hanging bracket and cover it with the canopy.

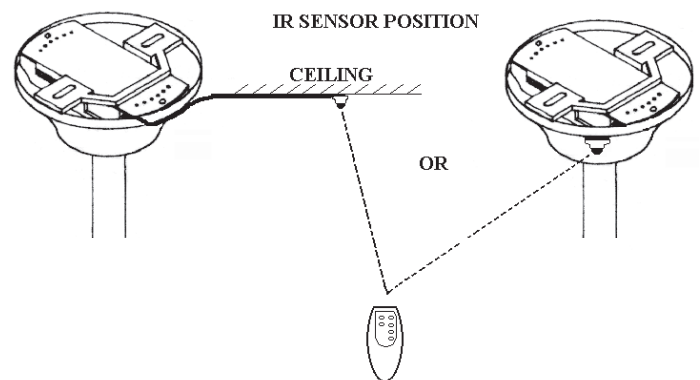
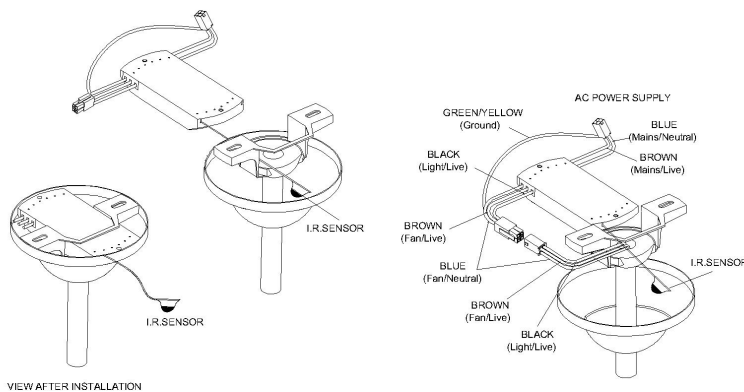

5. To change the batteries just to slide out the cover. Remote use 2pcs x 1.5V/AAA batteries.

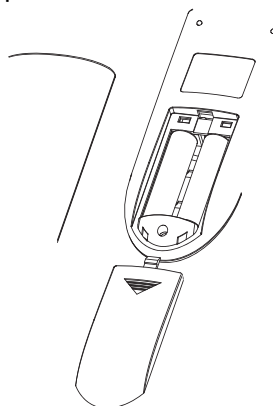

Installation of transmitter wall mount holder with two screws.

