

FIREFLY01A

LED GIMBAL WHITE RECESSED DOWNLIGHT DIMMABLE TRI-CCT

3000K

4000K

5700K

- Input voltage: 220-240V
- External Constant Current LED driver included
- Degree of tilt: 20°
- Housing & heatsink: plastic & aluminium
- Diffuser: clear PC
- Faceplate: plastic
- LED chip: 1pc COB
- Colour temperature changeable: 3000K/ 4000K/ 5700K
- CCT switch on driver
- CRI: >80
- Power factor: >0.9
- Flex & plug: 0.6m
- Ambient temperature: -20 to 40°C
- Suitable for dimming
- Suitable for 2-way switching
- Suitable for use with PIR & Microwave sensors

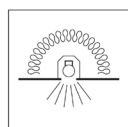
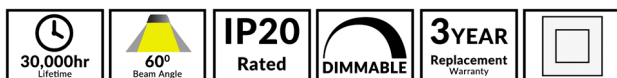

FIREFLY01A



CENTRE TILT: 20°



CCT SWITCH ON DRIVER

Tested & recommended dimmers:

BRAND	PART NO.
CLA	LYNX
CLIPSAL	32E450TM, 32ELEDM
HPM	CAT400T
DIGINET	MEDM, MMDM/RT

For Tested and Recommended Dimmer

*Please check with Licenced electrician for Min and Max dimmer load

*May be compatible with other untested dimmers

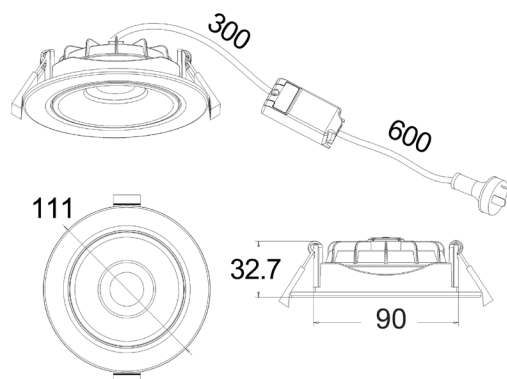

PART NO.	DESCRIPTION	LUMENS (LM)			WATT	CRI	PRODUCT DIMENSIONS (mm)	CUT OUT (mm)	BOX WEIGHT (kg)	BOX DIMENSIONS (cm)	CARTON QTY
		3000K	4000K	5700K							
FIREFLY01A	D/L LED GIMBAL DIMM WH RND Tri-CCT	640	720	720	8W	>80	Ø111X32.7	Ø90	0.2kg	12x12xx8	1/40