

LED GU10 TRI-CCT GLOBE (6W)

- Input voltage: 176-264V AC
- Diffuser: plastic clear
- Housing: plastic & aluminium
- Heatsink: PBT
- LED chips: 10pcs SMD2835
- Tri-CCT (3000K/ 4000K/ 5000K)
- CCT switch on housing
- CRI: ≥80
- Power factor: ≥0.5
- Ambient temperature: -20 to 40°C
- Not suitable for dimming
- Suitable for 2 way switching
- Suitable for use with sensors

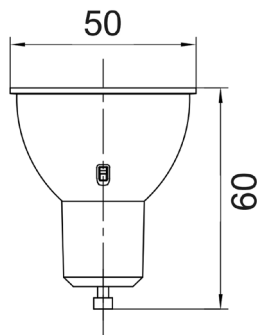

Part No.	Description	Lumens			Watt	Size	Box Weight	Box Size	Carton QTY
		3000K	4000K	5000K					
GU10TRI1	GLOBE LED GU10 6W TRI	432lm	495lm	605lm	6W	Ø50x60mm	0.45kg	5x6x7cm	1/10/100