

WIRING DIAGRAM FOR REMOTE ONLY

The diagram illustrates the wiring for remote control operation. It shows a power source (N, L) connected to a switch. The switch has a BLUE line going to a terminal block and a BROWN line going through a light fixture to the same terminal block. The terminal block is connected to a remote control receiver via a quick connector. The receiver is also connected to a fan motor and an LED light via quick connectors. A LED power adapter is shown connected to the receiver and the fan motor, with a note to leave it disconnected if present.

GREEN/YELLOW

N

L

BLUE

BROWN

TERMINAL BLOCK MOUNTING BRACKET

BLUE

BROWN

REMOTE CONTROL RECIEVER

BLUE

BROWN

Speaker

WARNING: For your safety, ensure the mains supply is switched OFF to the wiring circuit before performing any electrical wiring tasks.
MAKE THE WIRING CONNECTION AS SHOWN IN THE APPROPRIATE IMAGE.

CAUTION:

- Always have your fan installed by a licensed electrician.
- This appliance is not intended for use by persons (including children) with reduced physical, sensory or mental capabilities, or lack of experience and knowledge, unless they have been given supervision of instruction concerning use of the appliance by a person responsible for their safety.
- Children should be supervised to ensure that they do not play with the appliance.
- Make sure to disconnect the power supply before cleaning and maintenance.

USING YOUR REMOTE HANDPIECE

Step 1: Turn “ON” isolation switch.

NOTE: For models “with light”, light will default to “ON” at 100% output.

Step 2: Use Eco/Med/High buttons to alter the fan speed.

WITH LIGHT MODELS

Step 3: Press Light “ON/OFF” for light.

Step 4: Press the “STEP DIM” button to transition through 75%, 50%, 25% then back to 100% of light output.

(The units come factory paired, but if you wish to pair a remote handpiece to multiple fans, see below)

Step 1: Turn “OFF” isolation switch.

Step 2: Turn “ON” isolation switch and within 10 seconds, press LIGHT “ON” button for 3-4 seconds until a “Tick-Tack” sound is heard. (Repeat steps above if not successful).

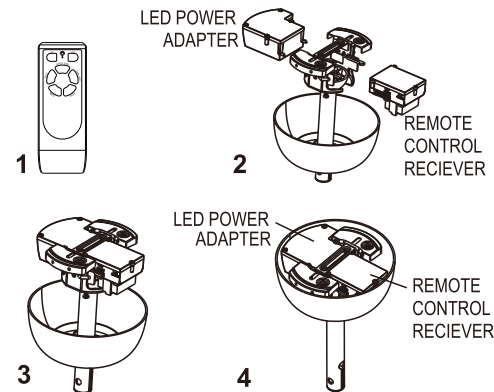

VENTAIR PTY. LTD.
4 Capital Place,
Carrum Downs VIC 3201

RF REMOTE CONTROL
SPYRFRDIM

TO SUIT SPYDA CEILING FAN

MADE IN CHINA